

NEW OWNERSHIP. WORLD-CLASS EXPERIENCE.

CBRE GLOBAL INVESTORS IS BRINGING ITS WORKPLACE EXPERTISE AND TENANT DEDICATION TO PASADENA TOWERS.

- \$86 billion in assets under management*
- Highly responsive to inquiries and concerns
- Strong commitment to tenant satisfaction and success
- Exclusive 5-Star Worldwide program of amenities and services

HERE ARE JUST A FEW OF THE TOP-TIER OFFICE PROPERTIES IN OUR PORTFOLIO:

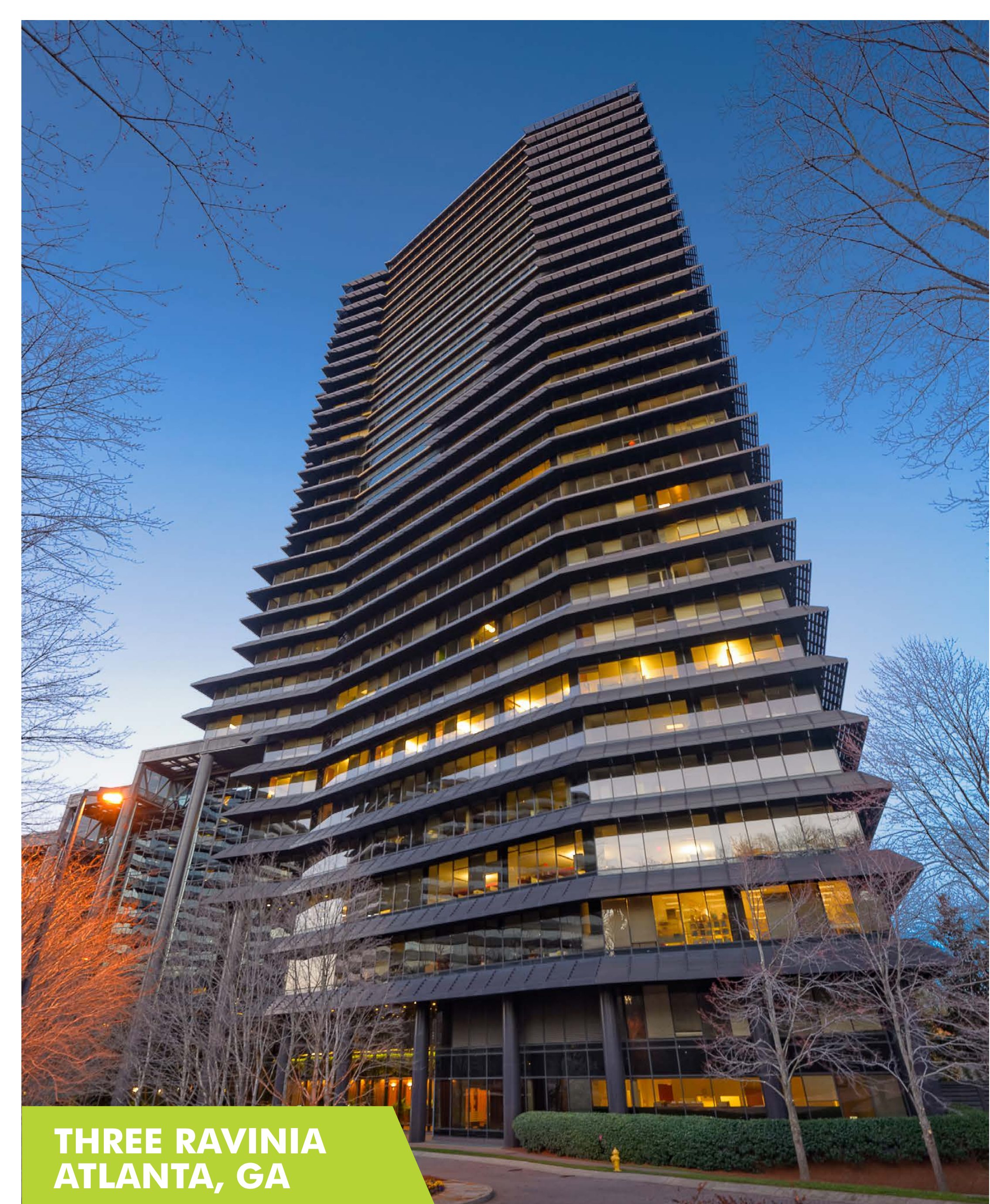

QUESTIONS? CONTACT YOUR 5-STAR MANAGER:
CHRYSTAL MONTES | +1 626 793 8817 | chrystal.montes@cbre.com

FIRST-CLASS SERVICE



Chrystal Montes

+1 626 793 8817

chrystal.montes@cbre.com

YOUR 5-STAR MANAGER WILL TAKE CARE OF EVERYTHING THAT CAN BE PLANNED, COORDINATED OR ARRANGED.

- Conference Center reservations
- Meeting planning assistance
- Catering and vendor coordination
- Specialty corporate events and networking programs
- Travel and dining reservations
- Corporate/personal gifts
- Theater and concert tickets
- Tours

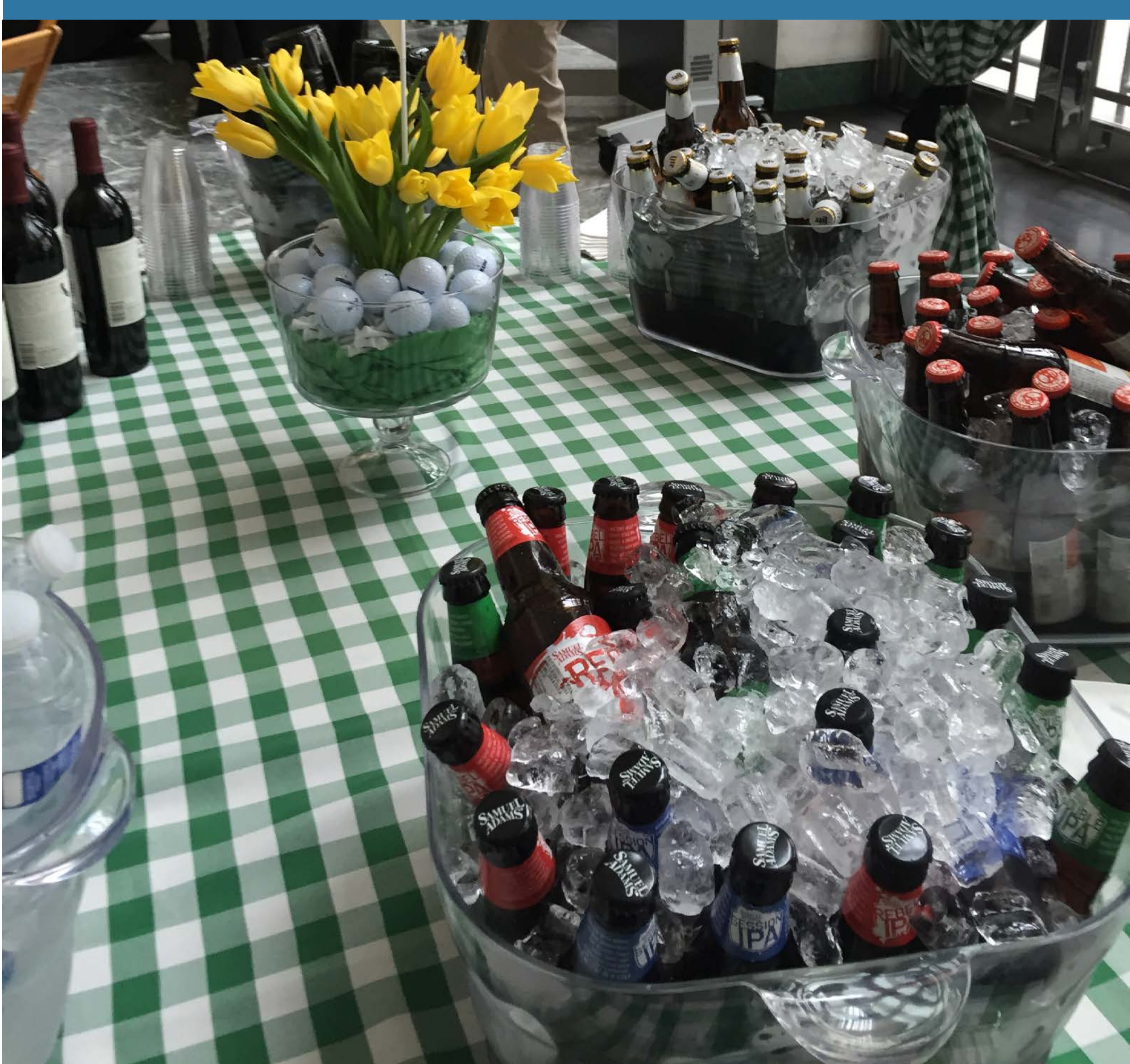

QUESTIONS? CONTACT YOUR 5-STAR MANAGER:
CHRYSTAL MONTES | +1 626 793 8817 | chrystal.montes@cbre.com

NATIONWIDE REACH



AS AN EXCLUSIVE MEMBER OF THE **5-STAR CONNECT** NETWORK, YOU HAVE PRIVILEGED ACCESS TO ANY 5-STAR WORLDWIDE PROPERTY – AND ITS AMENITIES – NATIONWIDE.

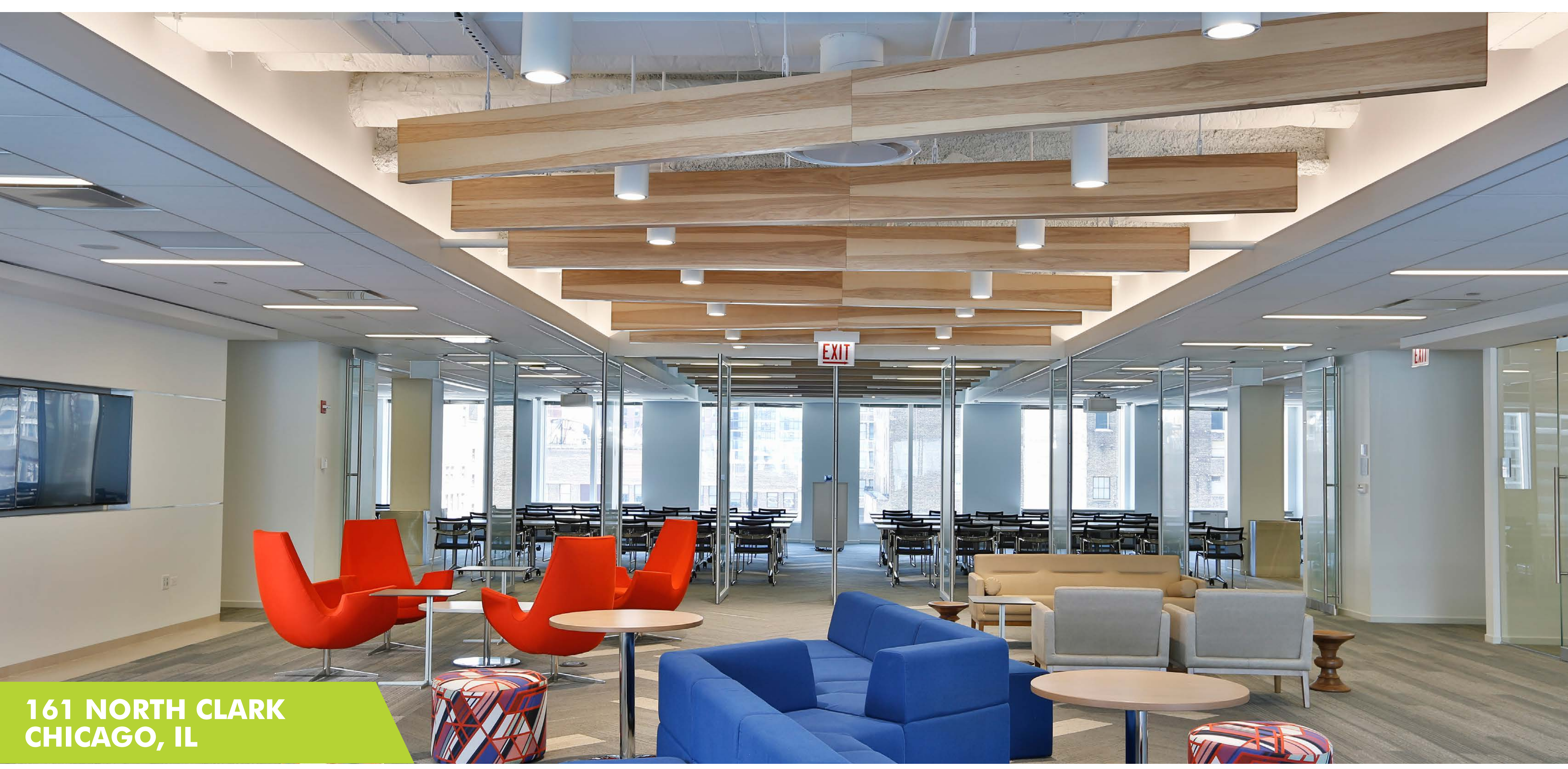

161 NORTH CLARK CHICAGO, IL



MET PARK SEATTLE, WA



100 HIGH STREET BOSTON, MA



THE LANDING AT MIA MIAMI, FL



THREE RAVINIA ATLANTA, GA

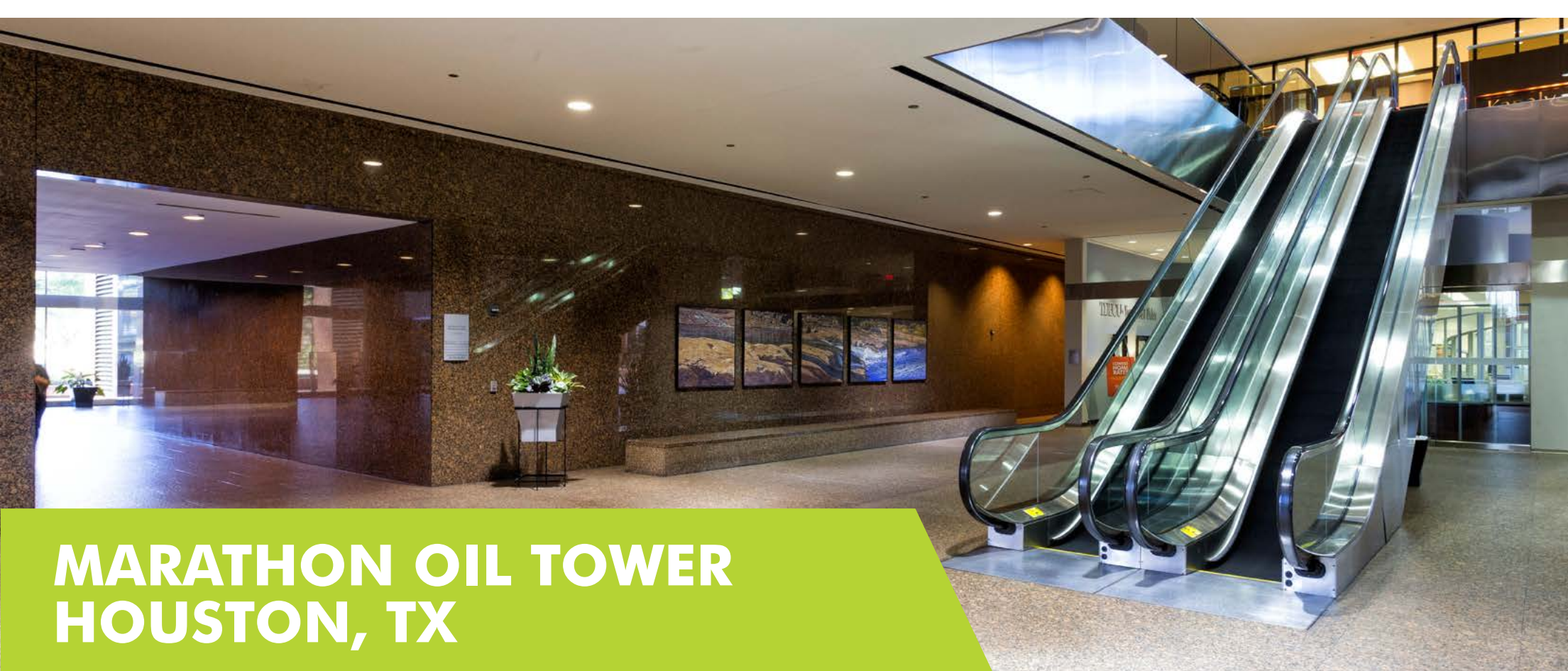

MARATHON OIL TOWER HOUSTON, TX



SIGNATURE EXCHANGE DALLAS, TX

- State-of-the-art wellness centers
- Collaborative co-working spaces
- Event-worthy rooftop decks
- Professionally equipped seminar/conference centers
- And much more

QUESTIONS? CONTACT YOUR 5-STAR MANAGER:
CHRYSTAL MONTES | +1 626 793 8817 | chrystal.montes@cbre.com



www.5-starworldwide.com

